



ASHOK LEYLAND

Aapki Jeet. Hamari Jeet.

**BUILD YOUR
OWN TIPPER**

4825 SERIES
10X4 TIPPERS

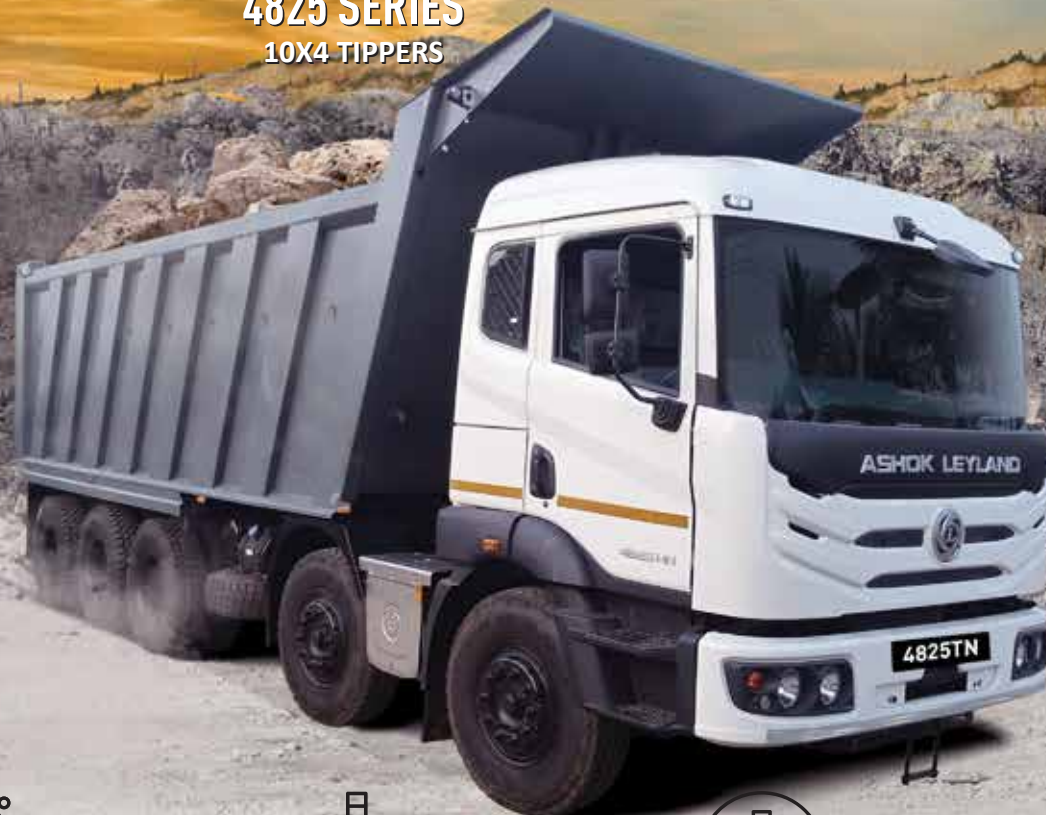

Superior TCO



Rugged and reliable
aggregates



Best-in-Class Safety



HINDUJA GROUP

ASHOK LEYLAND i-Gen6 ADVANTAGE

Over the years, Ashok Leyland Ltd., strove to deliver performance beyond excellence with inline or 'SAADA' pump for BS-III and iEGR technology for BS-IV.

Now with BS-VI, taking the proven iEGR technology up a notch, we are introducing the i-Gen6 engine technology which enhances the engine performance and durability further. With lower Diesel Exhaust Fluid (DEF) consumption and compact design, i-Gen6 lowers the cost of operation, offering better fluid efficiency and low maintenance. The unique Mid-NOx strategy ensures overall lower cost of ownership.

Innovative



Improved efficiency -

- Controls NOx generation within the engine itself



Lower TCO -

- Lower Diesel Exhaust Fluid (DEF) consumption
- Lower operational cost

Intelligent



Simple functioning -

- Lesser number of sensors



Improved life of Exhaust After Treatment System

- Patented air-assisted DEF injection and unique HC dozer
- Lower maintenance cost

Indian



Mid-NOx technology

- iEGR + SCR
- Higher fluid efficiency



Highly robust -

- Best suited for Indian driving condition

- Superior mileage: Proven iEGR engine combined with innovative air intake system and exhaust treatment offers higher performance
- Longer active regeneration intervals: Ensures longer DPF life
- Compact Exhaust After Treatment System: Allows flexibility in packaging / better space utilisation
- Larger Diesel Exhaust Fluid (DEF) tank: Coupled with lower consumption, ensures less frequent DEF refills
- Shortest first pipe length in exhaust system: Best-in-class thermal management

AVTR - THE ALL NEW TRULY MODULAR TRUCK RANGE

The brand name 'AVTR' is derived from the 'Avatar'. It refers to manifestation or version. The name reflects the flexibility, customization and choice exercised by the customer to develop the most judicious and optimized version of the vehicle. AVTR is a revolutionary, industry first modular truck platform from Ashok Leyland that is powered by i-Gen6 technology. AVTR's incredibly diverse range of options lets you customize your truck based on your load, terrain, and application requirements. Your power to choose is spread across the entire range from 18.5-55 tons. The AVTR range of trucks come with multiple options of axle configuration, loading spans, cabins, suspensions, drivetrains on a single platform. This is not just a revolution in customization, it's a game changing innovation that offers you a whole new trucking experience. The AVTR range comes with a promise of improved reliability, performance and overall TCO advantage. With AVTR, we believe that you should be able to build your trucks just like you build your success – your way. We take the leap to the future, where you dream, and we deliver.

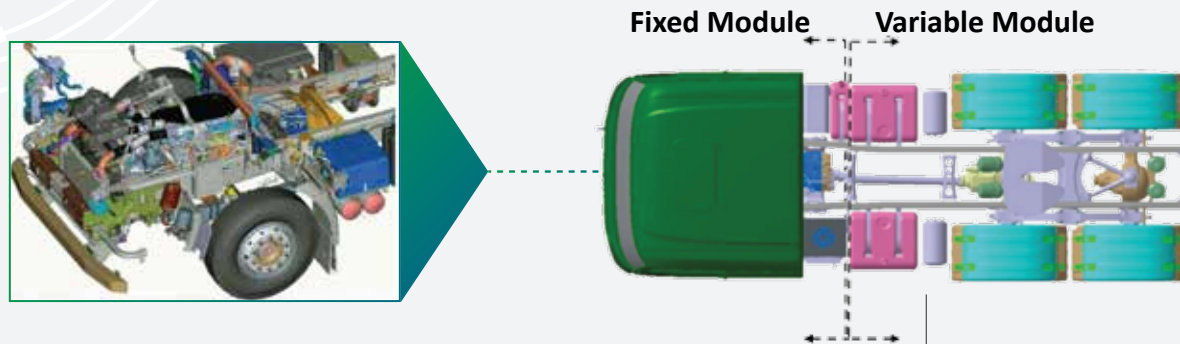

Wide range of Trucks



Wide range of Tippers



Wide range of Tractors

BUILD YOUR OWN TIPPER

Modular design now allows to build your own truck to suit your operational requirements like

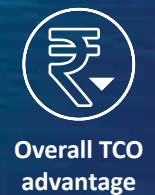
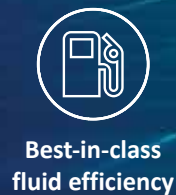

AGGREGATE DETAILS



i-Gen6 A Series Engines

- Power 250Hp @ 2200 rpm
- Torque 900Nm @ 1100 - 1800 rpm
- Better fuel efficiency
- Better NVH characteristics
- High power and high torque at low speeds
- In-house manufacturing
- Four valves per cylinder for improved volumetric efficiency
- Engine brake available

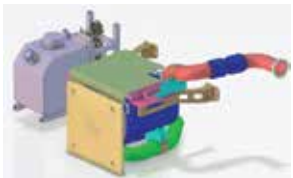

Compact EATS

- Single systems across multiple vehicles
- Compact design
- Higher durability
- Longer DPF regeneration intervals
- Longer DEF filling interval



ZF - 9 Speed Gearbox

Proven design by ZF, world leaders in gearbox technology

- Higher reliability and durability
- High gradeability (more than 50%)
- High load carrying ability
- Lowest cost of service
- 3000Hrs Oil change period

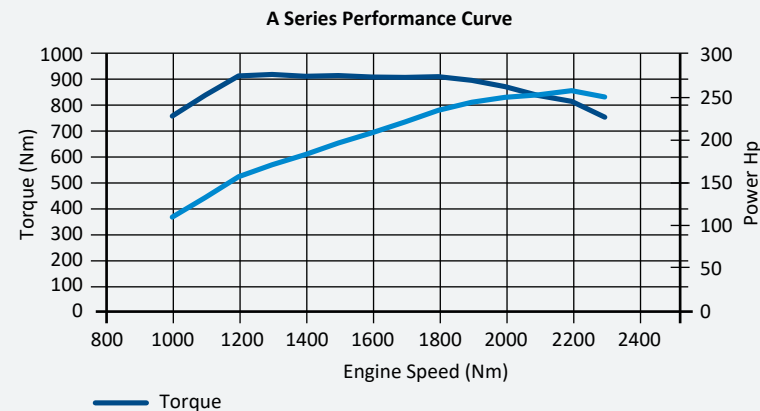

Wider RPM range

- Better pickup
- Lesser gear shifting
- Higher fuel efficiency
- Improved driver comfort

AGGREGATE DETAILS



Rear Axle

- 5.86:1 Ratio based on the load and road chosen
- Heat treated crown wheel pinion
- Parallel U-bolt arrangement
- Oil change period 2000Hrs



Propeller shaft

- Lube for life UJ across all series - greasing eliminated
- Double honeycomb rubber for enhanced damping
- Series 590 + C2040

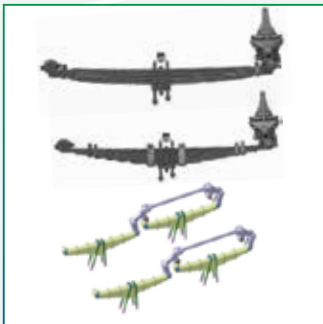

Suspension

- In front Both multi-springs and parabolic options available
- Higher shackle pin dia
- Anti-roll bar and shock absorber at front available
- 1650mm span at Front 1270mm Span at Rear for better ride and handling
- Parallel U-bolt arrangement
- Heavy duty spring brackets



Clutch Assembly

- 380mm Dia clutch plates
- Higher clutch plate file
- No greasing points in entire clutch actuation system
- Hydraulic actuation with clutch booster
- Low driving fatigue for longer hours of operation
- Higher durability

AGGREGATE DETAILS



Front axle

- Heavy duty front axle with greater load bearing ability
- Higher wheel lock angle and smallest turning radius among competition
- Higher Wheel lock angle for lower turning circle diameter
- Easy maneuverability
- Anti roll bar with Suspension available



Rugged box body

- 29cum Capacity BSK46 Material Box body
- Full length sub frame provided
- Additional internal flitch for higher strength
- Longer cleat plates for higher strength
- Hat section Cross Bearers
- Body prop's are provided on both sides to ensure safe maintenance work.
- Various Box body capacities available



Brake system

- 10bar system pressure – more free air buffer in the system for improved braking
- 318 cc Air Compressor – faster filling of air despite additional storage of air in auxiliary system



Heavy duty hydraulic cylinder

- 174mm dia FE cylinder
- Higher buckling withstand capacity & better lateral stability
- Ashok Leyland in-house support -Warranty will be attended at dealers
- Trained manpower -Better workshop TAT

AGGREGATE DETAILS

Tilt sensor fitted under the body



Anti-Toppling Kit

ATK (Anti toppling Kit) valve to control the tipping and valve to cut off the tipping based on feedback from roll over safety system (Sensor)



Dual Tyre Lift axle

- In house development – Robust for Indian conditions
- Pressure Limiting valve limits the pressure to LA System for Better Bellow Life
- Lift axle valve with inbuilt Logic - Better tyre life



Captain sleeper Cabin

- Full front metal jacket (No fiber)
- Crash test approved
- Low cost of repair, easy to repair, higher life
- BIC Lowered cab with 3 step entry - Better ingress & egress, Better visibility
- Comfortable sleeper cabin

AGGREGATE DETAILS

SPECIFICATIONS

Engine type	A series 6-cylinder CRS with iGen6 Technology Engine brake available
Maximum Power	250 HP @ 2200 rpm
Maximum Torque	900 Nm @ 1100 - 1800 Rpm
Clutch	380 mm dia , Diaphragm type with single plate Ceramic with clutch booster
Gearbox	9 speed synchromesh – CGR - 12.73
Propeller shaft	3+1 Propeller Shafts
Rear Axle	Fully floating single speed rear axle, Hypoid differential RAR: 5.86:1
Front axle	FA99 Forged I section – Reverse Elliot type
Steering	Hydraulic assisted power steering
Frame	275 X 75 X 8 mm – Bolted construction, Constant width

Cabin options	Captain WIM Sleeper cabin
Front Suspension	Semi-elliptic multi leaf, Optional Parabolic, 90mm Spring width
Brake	NRS - 90mm Spring width
Rear Suspension	Full air dual line brakes with ABS with ASA Parking brakes on rear wheels only
Fuel tank	300L cross-linked polymer Fuel Tank on LH side
Ad blue tank	~24 Lts capacity on RH side
Electricals	150 AH batteries 2x12V 85Amps alternator
Gradeability	23.5%
Tyre options	295/90R20 295/95D20 11x20 16PR 11R20 16PR
GVW	47500 Kg

Wheelbase(mm)	6600mm	6600mm
Load body	16 Cum Box	29 Cum Box

SCHEMATIC LAYOUT



e-DIAGNOSTICS

- Mobile phone - Bluetooth connectivity based diagnostic app to pinpoint the error code of the vehicle ECU
- Guided trouble shooting list pops up to help the technician solve the error
- Step by step visual aids for the technician

LEYKART

- Offers round the clock availability of spare parts
- Easy search for parts using the vehicle number
- Secure online payment options
- Track orders on mobile and get parts delivered to doorstep



SERVICEMANDI

- Connects digitally trained and certified workshops across the country
- Hassle-free service experience through mobile apps
- Live updates of vehicle repair on mobile

RECON

- Factory built high quality reconditioned engines
- Dynamometer tested engines offering high reliability and performance
- Pan India warranty

LEYPARTS®

- Comprehensive range
- Value for money
- Available at the nearest outlet
- Now in tamper-proof, newly designed cartons

VALUEPARTS

Right-fit for Ashok Leyland vehicles

- Right fit for Ashok Leyland vehicles

QUICK RESPONSE

- Response within 4 hours
- Restoration within 48 hours

EXTENDED WARRANTY

- Extended warranty available for longer coverage / period
- Quality and skilled manpower
- Improved TAT
- Genuine spare parts
- Competitive pricing
- Insulates customer from unknown failures / expenses
- Pan India support

AMC

- One-stop service solutions
- Flexible maintenance packages
- Pan India service
- Better resale value

SERVICE TRAINING

- Training service team to ensure quality, productivity and profitability

DRIVER TRAINING

- 11 Driver Training Institutes across India
- Institutes equipped with contemporary vehicles, simulators and modern infrastructure
- State-of-the-art training for drivers of customers, fleet owners and general public

HELPLINE

1800-266-3340

AUTHORISED DEALER:

Registered Office - Ashok Leyland Limited, No. 1, Sardar Patel Road, Guindy, Chennai - 600032, Tel. - +91 44 2220 6000
E-mail - reachus@ashokleyland.com | Website - www.ashokleyland.com | Helpline Number - 1800 266 3340

Specifications given in the booklet are subject to change



HINDUJA GROUP